

- 2 cylinders in line
- 440 cm³
- 4.0 kW/5.4 HP @ 3600 rpm
- 8.5 kW/11.5 HP @ 4400 rpm
- Nm. 25@2000 rpm

Homologation

- EURO 2 (EURO 3) Quadricycle

Construction

- 4-stroke diesel engine with 2 cylinder in line
- Liquid-cooled (loose radiator with electrical fan optional)
- Tilted position of 40° towards exhaust and inlet manifolds
- Die-casted aluminium engine block with re-borable cast iron integral liners
- Aluminium cylinder head
- “Uni flow” intake and exhaust manifold cab side
- Exhaust manifold complete with thermal protection
- Dry air cleaner on the flywheel side
- Breather return oil steam
- Double balance shaft
- Belt- driven Single overhead camshaft
- Rocker arm with hydraulic tappets
- Direct injection “common rail” system with electronic control
- High pressure pump on cylinder head
- Forced lubrication with vane pump
- Full flow external oil filter
- High capacity denoised oil sump
- Water pump in engine bloc
- Heating cab system provision
- Electrical starting with starter motor and external alternator (40 Amp)
- Pre-heating glow plugs controlled by the ECU



- Complete electrical harness and fuses box
- Single connector cab interface
- Denoised cover

CVT characteristics

- Dry centrifugal clutch on driving pulley
- Engine brake effect with shaft on driving pulley
- Free wheel device

Reduction gear / Differential

- Transmission range: 1 gear forward and 1 reverse
- Two speed ratio available
- Helicoids teeth pinion
- Speed detector for electronic vehicle speedometer

Main applications

- Mini cars
- A.T.V. (All Terrain Vehicles)

Specifications

Cylinders	N.	2
Displacement	cm ³	440
Bore	mm	68.0
Stroke	mm	60,6
Compression ratio		20:1
Combustion	degrees	360
Rating kW/HP max	N (80/1269/CEE) ISO 1585	8.5/11.5
Max torque	Nm	25@2000
Min.idle speed	rpm	1000
Water pump delivery at 5000 rpm	l/min	55
Oil consumption	kg/h	0.004
Oil sump capacity	l	2+0.1
Max allowable inclination for short period of operation (peak value)	degrees	30° (20°) *
Air combustion volume @ 3600 rpm	m ³ /h	41
Air combustion volume @ 4400 rpm	m ³ /h	49
Dry weight	kg	70
Recommended battery	V/Ah	11/44 400 A (EN)
Starter	kW	1.1

* Intake/Exhaust manifold side

CVT Specifications

Continuous variation ratio		0.38 - 2.2
Transmission range		5.8
Clutch connection rate	rpm	1200

Reduction gear / Differential Specification

Transmission range	1 forward motion – 1 reverse motion	
Speed ratio (forward-reverse)	12.25 : 1 – 10 : 1	
Gearbox oil	l	1
	Type	ZC75 SYNTH
Speed sensor for electronic speedometer	"effect hall"	



Sound pressure level dB (A)

Sound level polar diagram open field – 7 meters micro-phone
– no load running engine

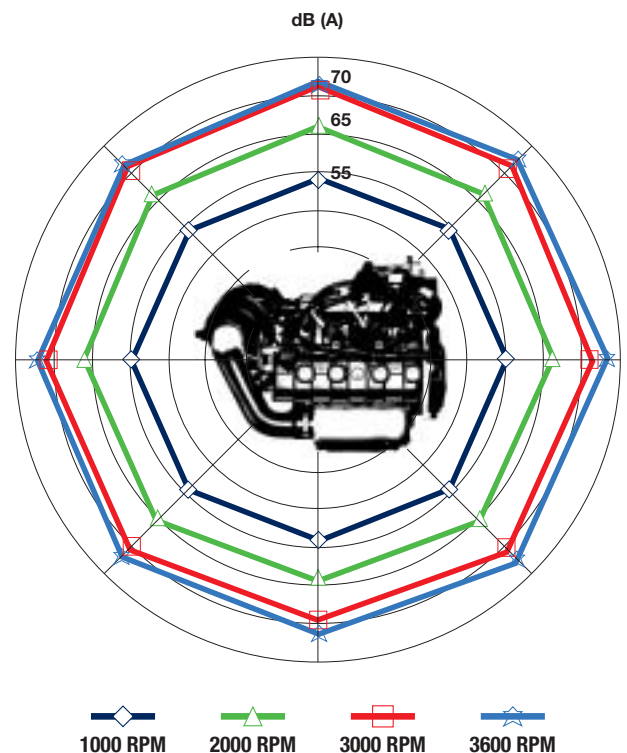

Curves

LDW 442 CRS automotive @ 3600 r.p.m. ■

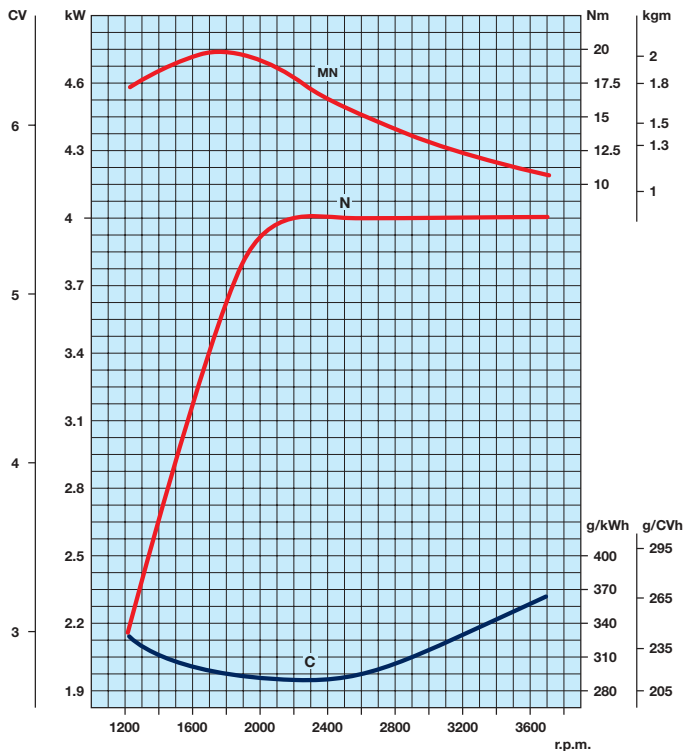

LDW 442 CRS @ 4400 r.p.m. ■

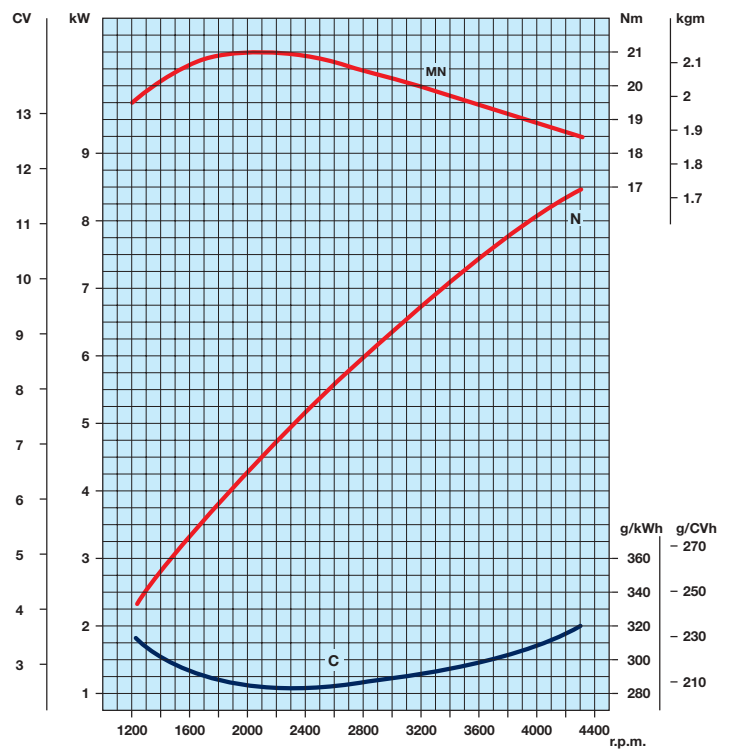

- N** Power curve - 80/1269/CEE - ISO 1585 -
- MN** Torque curve - (N curve)
- MB** (B curve - **MA** (A curve)
- C** Specific fuel consumption - (NB curve)

CT Move Exploded drawing

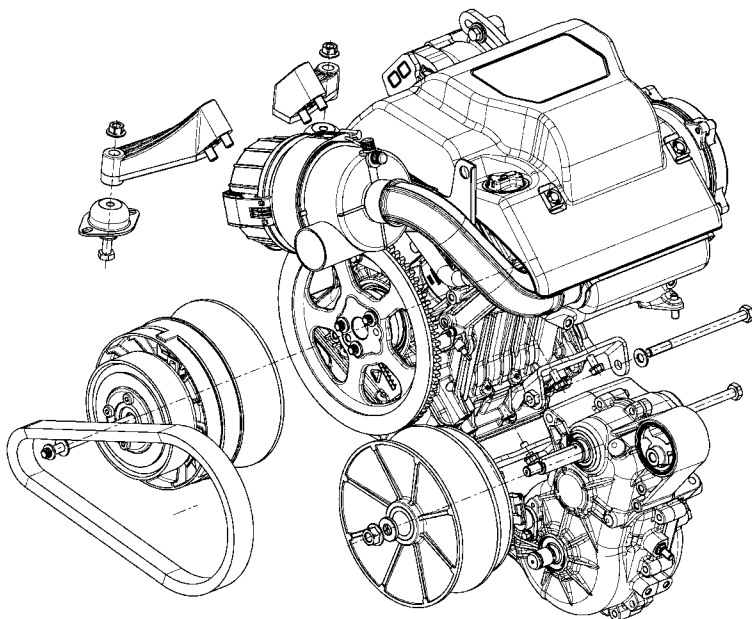

Technical drawings *

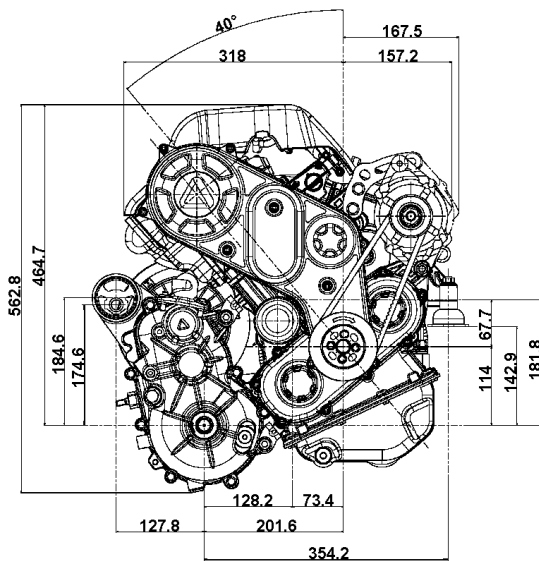
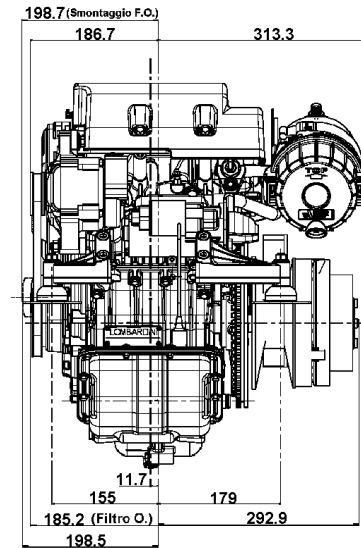
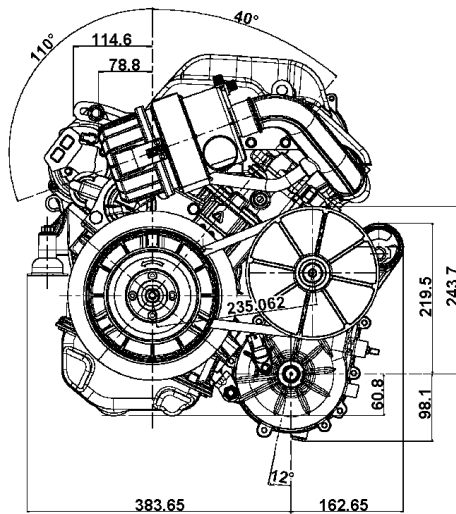

Standard equipment

- Accelerator pedal with potentiometer
- Fuses and relays box
- Engine electronic control unit (ECU)
- Fuel filter with water indicator
- Three anti-shock absorber elastic plates (2 forward and 1 rear)
- Electrical fuel feeding pump

* More specific dimensions are available on www.lombardini.it (see table at the bottom of the page)



ISO 9001 Cert. n. 0446 - 1405
QS. 9000 Cert. n. 2231/0



Via Cav. del Lavoro Adelmo Lombardini, 2
42100 Reggio Emilia - Italia
Tel. ++39 0522.3891 - Fax ++39 0522.389503
www.lombardini.it

LOMBARDINI RESERVES THE RIGHT TO MAKE MODIFICATIONS WITHOUT PRIOR NOTICE

09/2006 - cod. 3558294